



Maximize corrosion resistance.

PSDS30SR, PSDS60SR, PSDS60HPSR, PSDS100SR

Legrand's 316-Grade Sloped-Roof Stainless Steel Safety Switches are designed to provide superior corrosion resistance in harsh environments like food and beverage processing plants where wash-down/hose-down at extreme temperatures is a daily necessity, as well as in applications where salts, acids and chemicals are prevalent. Legrand's Sloped-Roof Stainless Steel Safety Switches with NEMA 4X/12, IP66/67/69 ratings are the best solution for durability and personnel safety in any environment.

Features & Benefits

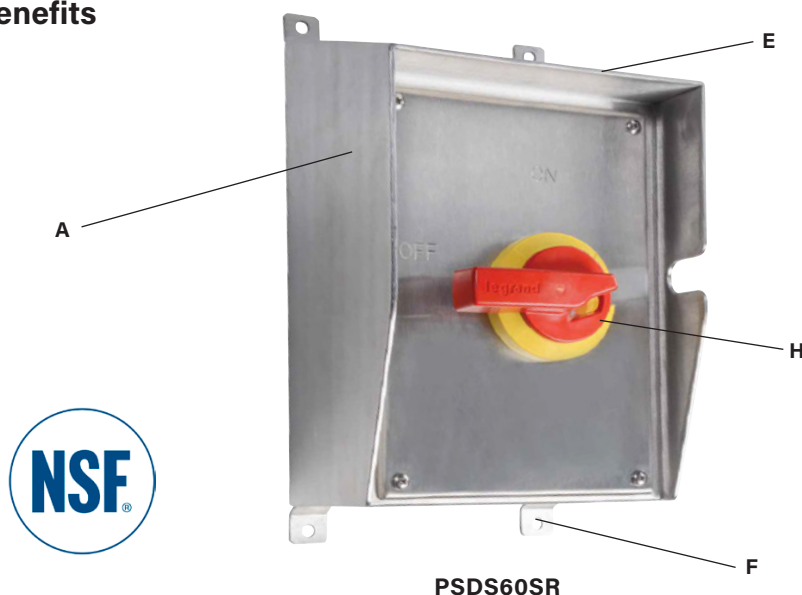

PSDS60SR

- A. Type 316 grade stainless steel** provides superior resistance to corrosion.
- B. 6 conduit entry points** for flexible installation options.
- C. Certified by the National Sanitation Foundation (NSF)** for hygiene requirements in food and beverage processing.
- D. Can accommodate up to 3 sets of auxiliary contacts** for control circuit applications.
- E. 5° sloped roof** helps to facilitate run-off and minimize the harborage of contaminants.
- F. 3/4" standoffs on mounting feet** allow adequate space for runoff and inspection behind the switch.
- G. Water- and dust-tight enclosure** rated **NEMA 4X/12** and **IP66/67/69** for protection against high-pressure, high-temperature water from multiple directions.
- H. High-visibility yellow and red handle** can be padlocked to meet OSHA lockout/ tagout requirements.

Compliance



UL Listed 767A File #E31169; Complies with CSA standards; NSF Approved;
NEMA 4X, 12; IP66, IP67, IP69; OSHA Compliant

Technical Information

Performance

Electrical

Dielectric Voltage Withstand	3000V minimum
Maximum Working Voltage	600V RMS
Current Interrupting	Listed for current interrupting at full-rated current and voltage
Short Circuit Withstand Rating	For use on circuit capable of delivering not more than (see chart on back page) RMS amps at 600VAC
Operations	Mechanical: 10,000 cycles Electrical: 10,000 cycles
Auxiliary Contacts (optional)	10A @ 600VAC; 1 N.O. & 1 N.C.

Mechanical

Impact Resistance	Per UL746C
Terminal Identification	Per UL and CSA
Product Identification	Identification and rating on external and internal labels
Mounting	External adjustable feet with five (5) positions* Can be mounted directly to channel or strut

Environmental

Moisture Resistance	Per UL50, section 35, NEMA Enclosure Type 4X (watertight, hosedown) Per UL50, section 35, NEMA Enclosure Type 12 (dusttight, falling dirt) • IP66/67/69
Flammability	UL94 5VA and VO Classification
Operating Temperature	Maximum continuous: +60°C Minimum continuous: -50°C without impact
UV Resistance	All enclosure materials are UV stabilized

Materials

Enclosure Cover	316 Stainless Steel – 14 Gauge on 30A; 12 Gauge on 60/100A
Enclosure Base	316 Stainless Steel – 14 Gauge
Enclosure DIN Rail	316 Stainless Steel
Switch Handle	Valox 357®
Switch Base	Valox 357®
Switch Key	14% Glass-Filled Nylon
Cover Gasket	Silicone Foam
Handle Gasket	Silicone Foam
Mounting Feet	316 Stainless Steel – 12 Gauge
Cover Screws	316 Stainless Steel
Cover Screw O-Ring	Neoprene
Assembly Screws/Hardware	300 Series Stainless Steel

Warranty

1 Year



PSDS60SR, PSDS100SR



PSDS30SR

Mounting Dimension Table (inches)

	A	B	C	D	E
30 Amp	5.84	4.24	9.10	10.50	6.52
60/100 Amp	8.30	6.70	12.64	14.03	7.10

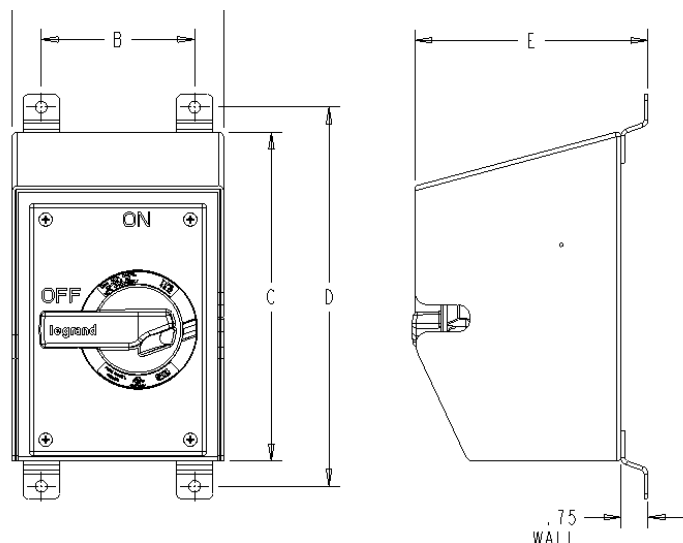

Ordering Information

Sloped-Roof Stainless Steel Safety Switches

VOLTAGE	MAXIMUM HORSEPOWER RATING	SLOPED-ROOF SAFETY SWITCH CATALOG NO.	SLOPED-ROOF SAFETY SWITCH WITH AUXILIARY CONTACT**	SLOPED-ROOF SAFETY SWITCH WITH 3 AUXILIARY CONTACTS**	AUXILIARY CONTACT KIT*	REPLACEMENT SWITCH	REPLACEMENT SWITCH WITH AUXILIARY CONTACT	REPLACEMENT SWITCH WITH 3 AUXILIARY CONTACTS	REPLACEMENT COVER FOR STANDARD SWITCH	REPLACEMENT COVER FOR AUXILIARY TYPE
30 AMPS 600VAC										
120 VAC	1.5 HP	PSDS30SR	PSDS30AXSR	PSDS30AX3SR	AX30	RS30	RS30AX	RS30AX3	PSDS30RC	PSDS30AXRC
208 VAC	3 HP									
240 VAC	5 HP									
277 VAC	5 HP									
480 VAC	7.5 HP									
600 VAC	7.5 HP									
3Ø 208Y/120 VAC	5 HP									
3Ø 240 VAC	10 HP									
3Ø 480Y/277 VAC	20 HP									
3Ø 480 VAC	20 HP									
3Ø 600Y/347 VAC	25 HP									
3Ø 600 VAC	25 HP									
60 AMPS 600VAC										
120 VAC	3 HP	PSDS60SR	PSDS60AXSR	—	AXD60	RS60	RS60AX	—	PSDS60RC	PSDS60AXRC
240 VAC	7.5 HP									
277 VAC	7.5 HP									
480 VAC	15 HP									
600 VAC	15 HP									
3Ø 240 VAC	15 HP									
3Ø 480Y/277 VAC	30 HP									
3Ø 480 VAC	30 HP									
3Ø 600Y/347 VAC	40 HP									
3Ø 600 VAC	40 HP									
60 AMPS HP 600VAC										
120 VAC	5 HP	PSDS60HPSR	PSDS60HPAXSR	—	AX60	RS60HP	RS60HPAX	—	PSDS60HPRC	PSDS60HPAXRC
240 VAC	10 HP									
277 VAC	15 HP									
480 VAC	20 HP									
600 VAC	30 HP									
3Ø 240 VAC	25 HP									
3Ø 480Y/277 VAC	50 HP									
3Ø 480 VAC	50 HP									
3Ø 600Y/347 VAC	50 HP									
3Ø 600 VAC	50 HP									
100 AMPS 600VAC										
120 VAC	5 HP	PSDS100SR	PSDS100AXSR	—	AX60	RS100	RS100AX	—	PSDS100RC	PSDS100AXRC
240 VAC	15 HP									
277 VAC	15 HP									
480 VAC	30 HP									
600 VAC	30 HP									
3Ø 240 VAC	25 HP									
3Ø 480Y/277 VAC	50 HP									
3Ø 480 VAC	50 HP									
3Ø 600Y/347 VAC	50 HP									
3Ø 600 VAC	50 HP									

*For replacement of side mount auxiliary contact on previous design.

**Auxiliary contacts break before switch contacts break for use with VFD.

Interrupting Ratings — RMS Symmetrical Amperes

Short Circuit Ratings: Suitable for use on circuits capable of delivering not more than (see chart below for cat. no. and application) RMS symmetrical amperes, 600VAC maximum.

Cat No.	KA	Fuse/Breaker	Max Size
PSDS30SR (AX)	10	RK1	—
	65	Class J	40A
PSDS60SR (AX)	10	RK1	125A
	65	Class J	70A
PSDS60HPSR (AX)	10	RK1	—
	10	GE Circuit Breaker	—
	65	Class J	100A

Stainless Steel Safety Switches are ideal for a wide range of applications including:

- Poultry Processing
- Seafood Processing
- Meat Processing
- Pharmaceutical Processing
- Food Packaging
- Food Preparation
- Agriculture
- Beverage Processing
- Health Care

Also available in the radiant® collection

- Mechanical Interlocks
- Flexcor® Wire Mesh Grips
- Turnlok® Locking Devices
- Portable GFCI
- IEC 309 Industrial Products
- Straight Blade Plugs & Connectors
- Ground Continuity Monitoring (GCM)



Legrand, North America
60 Woodlawn Street
West Hartford, CT 06110
877-295-3472
www.legrand.us
844-977-3783
www.legrand.ca

