

S SERIES M SERIES MOTION SENSORS

Cat.#

Job

Type



HUBBELL
Outdoor Lighting

Approvals

APPLICATIONS

- Security or welcome lighting. Sensor kits with floods or sensors only to control remote fixtures
- Sensors are molded bronze or white non-metallic housing, ball joint and 1/2" threaded knuckle

SPECIFICATIONS: S SERIES

- 270° detection field, broad 20-25 ft. detection range
- Surge protection; 600V, 1200A, 30 Joules
- Center focus range to 75 feet
- 1500 watt incandescent load capacity
- 120 volt, 60Hz
- Time On adjustment. Manual override
- LED-Unit in On indicator
- Test mode
- Sensitivity adjustment
- Listed to UL1598 for use in wet locations

SPECIFICATIONS: S SERIES SENSOR KITS

- White or bronze finish
- Sensor above plus (2) 150 watt PAR cast aluminum lampholders and 4" round cover plate
- Complete instructions for operation
- UL/C-UL wet location listed with lampholders aimed below horizontal

SPECIFICATIONS: M SERIES

- 130° detection field, broad 20 ft. detection range
- Surge protection; 600V, 1200A, 14 Joules
- Center focus range to 40 feet
- 500 watt incandescent load capacity
- 120 volt.60Hz
- Time On adjustment
- Sensitivity adjustment
- Night/Daytime or Night operation mode
- Listed to UL1598 for use in wet locations

SPECIFICATIONS: M SERIES SENSOR KITS

- White or bronze finish
- Sensor above plus (2) 150 watt PAR non-metallic lampholders and 4" round non-metallic cover plate
- Complete instructions for operation
- UL/C-UL wet location listed with lampholders aimed below horizontal



S0/SOW



S2LH/S2LHW



M0/MOW



M2LH/M2LHW

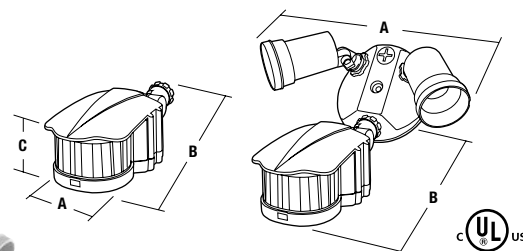

	A	B	C
S0	3 1/2" 89 mm	8" 203 mm	2 5/8" 67 mm
S2	10 1/2" 267 mm	8 1/2" 216 mm	

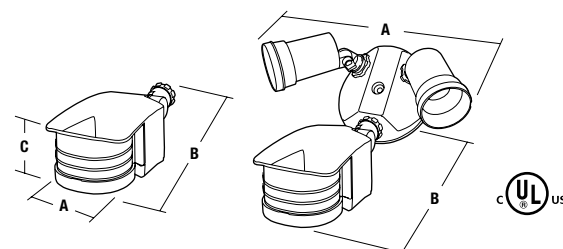

	A	B	C
M0	2 3/8" 60 mm	6" 152 mm	2 1/4" 57 mm
M2	10 1/2" 267 mm	6" 152 mm	

ORDERING INFORMATION

Catalog Number	Description	Weight lbs. (kg)
S Series		
S0	Sensor only, 270° detection range, bronze	0.7 (.32)
S0-W	Sensor only, 270° detection range, white	0.7 (.32)
S2LH	Sensor kit, twin 150w lampholders, cover plate, bronze	1.7 (.77)
S2LH-W	Sensor kit, twin 150w lampholders, cover plate, white	1.7 (.77)
M Series		
M0	Sensor only, 130° detection range, bronze	0.5 (.23)
M0-W	Sensor only, 130° detection range, white	0.5 (.23)
M2LH	Sensor kit, 130° detection range, twin lampholders, cover plate, bronze	1.2 (.54)
M2LH-W	Sensor kit, 130° detection range, twin lampholders, cover plate, white	1.2 (.54)



HUBBELL
Outdoor Lighting

Hubbell Outdoor Lighting • 701 Millennium Boulevard • Greenville, SC 29607 • Phone: 864-678-1000

Due to our continued efforts to improve our products, product specifications are subject to change without notice.

© 2014 HUBBELL OUTDOOR LIGHTING, All Rights Reserved • For more information visit our website: www.hubbelloutdoor.com • Printed in USA

SENSORS-SPEC 3/14