

P2868 - Beam Clamp

Features

- Use with P1000, P1100, P3000, P3300, P3301, P4000, P4001, P4100 and P4101 channels
- Beam flange widths: 4" to 18"
- J-bolt retains clamp to beam
- Includes center rod, U-bolt and hex nuts
- Load capacity governed strength of strut channel and beam flange
- This series is available in Electrogalvanized (EG)

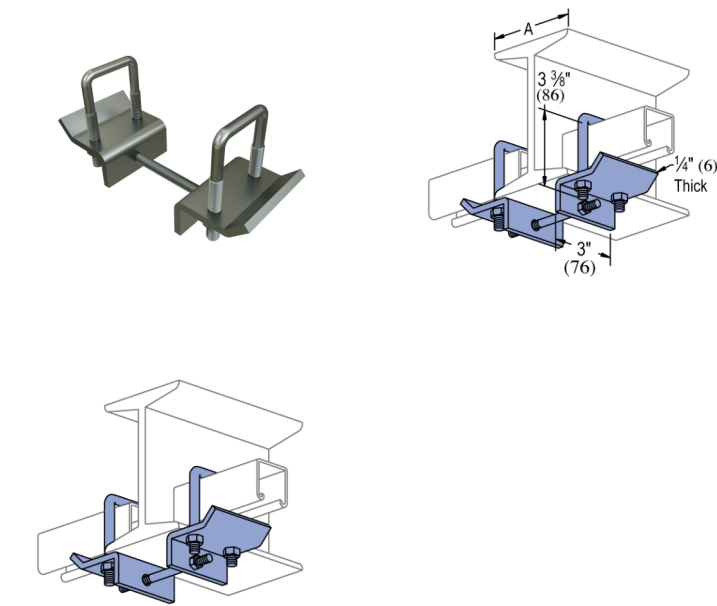

- Includes Center Rod, U-Bolts and Hex Nuts
- For use with P1000, P1100, P2000, P3000, P3300, P3301, P4000, P4001, P4100, and P4101 Channels

Materials & Finishes:

- **Electrogalvanized (EG):** Conforms to ASTM B633, Type III SC1 or SC3



Catalog Number	Trade Size	Material Type	Surface Finish	Part Weight (lb/ea)	Standard Package Weight (lb)
P2868 EG	4 ⁶	Steel	Electrogalvanized	2.8	28
P2868-9 EG	6 ⁹	Steel	Electrogalvanized	2.87	28.7
P2868-12 EG	9 ¹²	Steel	Electrogalvanized	2.94	29.4
P2868-15 EG	12 ¹⁵	Steel	Electrogalvanized	3.01	30.1