

P1271S - Beam Clamp

Parallel Beam Clamp is designed to be used when running the channel in the same direction as the beam.

Features

- Vertical Design Load: 500 lbs per clamp. Must use in pairs.
- Use with P1000 and P1100 channels
- Requires P1010 channel nut and bolt
- This series is available in ElectroGalvanized (EG), Atkore Defender (DF), Hot-Dip Galvanized (HG), and Stainless Steel (SS).

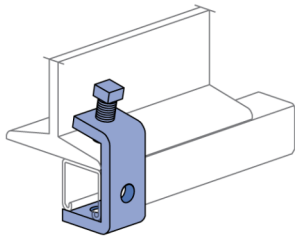
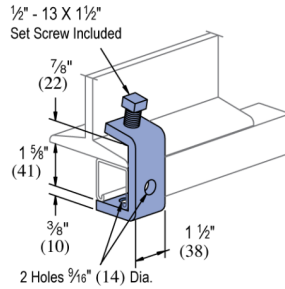

Standard Dimensions (Unless Shown Otherwise on Drawing):

- **Hole Diameter:** $\frac{9}{16}$ " (14mm)
- **Hole Spacing (From End):** $\frac{13}{16}$ " (21mm)
- **Hole Spacing (On-Center):** $1\frac{7}{8}$ " (48mm)
- **Width:** $1\frac{5}{8}$ " (41mm)
- **Thickness:**
 - $\frac{1}{4}$ " (6.4mm) with steel meeting or exceeding ASTM A1011 SS GR 33, or
 - 0.220" (5.6mm) with steel meeting or exceeding ASTM A1011 HSLAS GR 45

Note:

- When used for mechanical supports, load capacities of brackets and fittings should be in compliance with the American Standard Code for Pressure Piping.

Materials & Finishes - Standard:

- **Base Metal:** Steel conforms to ASTM A1011 SS GR 33, A1011 HSLAS GR 45, A36, A575, A576, or A635.
- **ElectroGalvanized (EG):** Conforms to ASTM B633, Type III SC1
- **Unistrut Defender (DF):** Conforms to ASTM A1059
- **Hot Dip Galvanized (HG):** Conforms to ASTM A123 or A153
- **Perma-Green (GR):** Conforms to commercial standards for powder coating
- **Perma-Gold (ZD):** Conforms to ASTM B633, Type II SC1 or SC3
- **Plain (PL):** No finish

Materials & Finishes - Special Metals:

- **Stainless Steel, Type 304 (SS):** Conforms to ASTM A240 or A276, Type 304 *
- **Stainless Steel, Type 316 (ST):** Conforms to ASTM A240 or A276, Type 316 *
- **Aluminum (AL):** Conforms to ASTM B209, Type 1100F or 5052-H32 *

* These materials have different physical properties and performance characteristics. Please contact us for design support.



Catalog Number	Material Type	Surface Finish	Part Weight (lb/ea)	Standard Package Weight (lb)
P1271S DF	Steel	Defender	1.01	25.25
P1271S EG	Steel	Electrogalvanized	0.95	23.75
P1271S GR	Steel	Green E-Coat	0.95	23.75
P1271S HG	Steel	Hot-Dip Galvanized	1.01	25.25
P1271S SS	Stainless Steel - 304		0.95	23.75
P1271S ST	Stainless Steel - 316		0.95	23.75

Design Load = 500 lbs (2.22 kN) each
Notes:

- 1. Design loads only apply to Unistrut brand products. Look for "UNISTRUT" on the part.
- 2. Use in pairs only.
- 3. Safety factor = 2.5 based on ultimate strength of connection.
- 4. Requires a P1010 Channel Nut and 1/2" bolt.
- 5. Set Screw Installation Torque: 125 in-lbs (14 N-m)