

# Rigid Steel Reducing Bushings -OL

**Size Range:** 1/2" -4"

**Product Series:** RB Reducing Bushings for Ordinary Locations

**Material:** Solid Alloy Steel Construction

**Zinc Plated with Chromate Finish \*\***

**Made in the USA**

**Features:**

Precision Machined Cut Threads

Smooth ID for EZ Fast Wire Pull

*Twice the Strength and Durability of Die Cast & Malleable Products*

## Industrial SPEC-grade

For Use on Rigid / IMC Conduit

Reduces the Threaded Opening on Conduit Bodies or any Female Threaded Fitting.

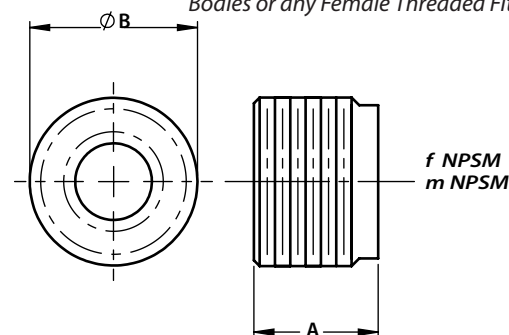

Ordinary Locations Steel Reducing Bushings



**Compliances:**

Certified Made in the USA

UL 514B, 467

NEMA Standard FB1

Federal Standard A-A-50553

CSA Standard: C22.2 No. 18F

RoHS Compliant

REACH Compliant

CA Prop 65 Compliant

UNSPSC 39121312



**Available Options:**

\*\* Galvanized Plating Option Available Add suffix "G" to cat #'s

Other Configurations and Material  
Hazardous Locations in Steel and Aluminum

Cat #	Trade Size	A	Ø B	Wt. Per/C
RB5038	1/2" x 3/8"	9/16"	13/16"	2
RB7550	3/4" x 1/2"	9/16"	1"	4
RB10050	1" x 1/2"	5/8"	1-5/16"	12
RB10075	1" x 3/4"	5/8"	1-5/16"	7
RB12550	1-1/4" x 1/2"	11/16"	1-5/8"	26
RB12575	1-1/4" x 3/4"	11/16"	1-5/8"	22
RB125100	1-1/4" x 1"	11/16"	1-5/8"	13
RB15050	1-1/2" x 1/2"	7/8"	1-7/8"	40
RB15075	1-1/2" x 3/4"	7/8"	1-7/8"	34
RB150100	1-1/2" x 1"	7/8"	1-7/8"	26
RB150125	1-1/2" x 1-1/4"	7/8"	1-7/8"	11
RB20050	2" x 1/2"	7/8"	2-5/16"	80
RB20075	2" x 3/4"	7/8"	2-5/16"	74
RB200100	2" x 1"	7/8"	2-5/16"	64
RB200125	2" x 1-1/4"	7/8"	2-5/16"	46
RB200150	2" x 1-1/2"	7/8"	2-5/16"	30
RB250100	2-1/2" x 1"	15/16"	2-13/16"	118
RB250125	2-1/2" x 1-1/4"	15/16"	2-13/16"	98
RB250150	2-1/2" x 1-1/2"	15/16"	2-13/16"	81
RB250200	2-1/2" x 2"	15/16"	2-13/16"	44
RB300125	3" x 1-1/4"	1-1/16"	2-7/16"	194
RB300150	3" x 1-1/2"	1-1/16"	2-7/16"	178
RB300200	3" x 2"	1-1/16"	2-7/16"	135
RB300250	3" x 2-1/2"	1-1/16"	2-7/16"	80
RB350150	3-1/2" x 1-1/2"	1-1/16"	2-15/16"	261
RB350200	3-1/2" x 2"	1-1/16"	2-15/16"	215
RB350250	3-1/2" x 2-1/2"	1-1/16"	2-15/16"	161
RB350300	3-1/2" x 3"	1-1/16"	2-15/16"	74
RB400200	4" x 2"	1-1/16"	4-7/16"	308
RB400250	4" x 2-1/2"	1-1/16"	4-7/16"	257
RB400300	4" x 3"	1-1/16"	4-7/16"	167
RB400350	4" x 3-1/2"	1-1/16"	4-7/16"	85