

**1**  
**PLACE T-BOLT INTO RAIL & SECURE BOLT:** Insert 3/8" T-bolt into rail at L-foot locations. Apply Anti-Seize to bolt. Rotate T-bolt into position.

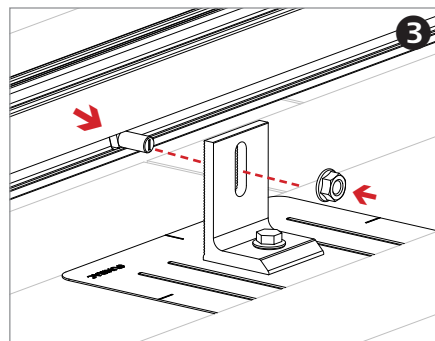

**3**  
**SECURE T-BOLT:** Apply Anti-Seize to bolt. Rotate T-bolt into position.

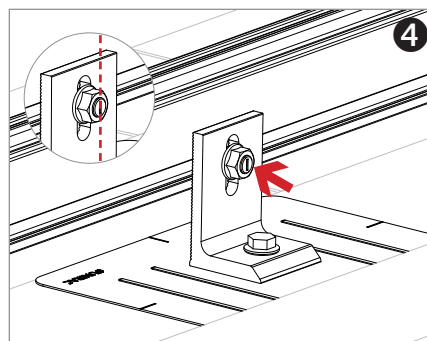

**4**  
**ALIGN POSITION INDICATOR:** Hand tighten nut until rail alignment is complete. Verify that position indicator on bolt is vertical (perpendicular to rail)

**TORQUE VALUE (See Note on PG. A)**  
3/8" nut to 30 ft-lbs

**ALIGN RAILS:** Align one pair of rail ends to the edge of the installation area. The opposite pair of rail ends will overhang installation area. Do not Trim them off until the installation is complete. If the rails are perpendicular to the rafters, either end of the rails can be aligned, but the first module must be installed at the aligned end.

If the rails are parallel to the rafters, the aligned end of the rails must face the lower edge of the roof. Securely tighten all hardware after alignment is complete.

Mount modules to the rails as soon as possible. Large temperature changes may bow the rails within a few hours if module placement is delayed.

